

SMA-M CONN .141SR DIRECT SOLDER

SC3041, SC3042

SPECIFICATIONS

ELECTRICAL:

FREQUENCY: 0-18 GHZ
 VSWR 1.3:1 MAX
 IMPEDANCE: 50 OHMS
 OP. TEMP RANGE: -55C- +155C

MECHANICAL:

MATERIAL BODY: STAINLESS STEEL
 INTERFACE: MIL-STD-883
 ROHS COMPLIANT

ASSEMBLY

TRIM CABLE AS SHOWN,
 SOFT SOLDER CABLE JACKET TO BODY,
 ASSEMBLE C RING & GASKET TO BODY,
 COMPRESS C RING & SLIDE BODY ASSEMBLY
 INTO COUPLING NUT UNTIL RING IS SEATED IN
 GROOVE & CABLE IS FLUSH WITH TEFLON,
 CHECK FINAL PIN DEPTH

SC3041 Au PLATED
 SC3042 PASSIVATED

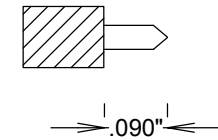
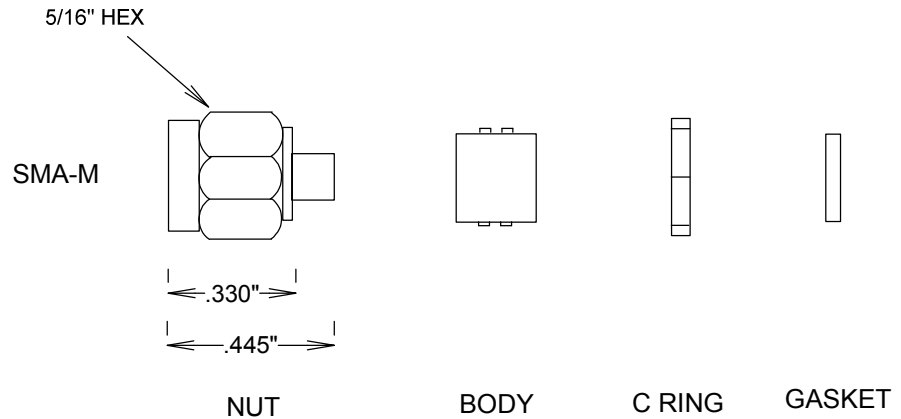

RECOMMENDED
STRIPPING

SEMIRIGID CABLE CENTER CONNECTOR IS CONNECTOR CENTER PIN

FAIRVIEW MICROWAVE INC.

ALLEN, TX 75013 WWW.FAIRVIEWMICROWAVE.COM

TITLE

SMA-M CONN .141SR DIRECT SOLDER

SIZE	CAGE CODE	DWG NO	REV
A	3FKR5	SC3041, SC3042	--

SCALE

SHEET