

N Male Connector Clamp/Solder Attachment For Harbour LL142 Cable

Type N male connector with clamp/solder attachment for Harbour LL142, part number SC7231, from Fairview Microwave is in-stock and ships same day. This type N male connector operates up to a maximum frequency of 18 GHz and offers excellent VSWR of 1.25:1.

Fairview's type N male connector SC7231 datasheet specifications and outline drawing are shown in this PDF below. Our extensive offering of RF, microwave and millimeter wave connectors allows designers to configure and customize their signal connections however they like. From providing an I/O for a board design to creating a custom cable assembly configuration, Fairview Microwave has a connector solution to meet your needs. Fairview Microwave also has the expertise to build your custom cable assemblies for you and ship them same-day.

Electrical Specifications

Description	Min	Typ	Max	Units
Frequency Range	DC		18	GHz
VSWR			1.25:1	
Insertion Loss			0.22	dB
Operating Voltage (AC)			335	Vrms
DWV (AC)			1,000	Vrms
High Potential Voltage 5 to 7.5 MHz			670	Vrms
Corona Discharge at 70,000 ft			250	Vrms
Insulation Resistance	5,000			MOhms
RF Leakage	90			dB

Mechanical Specifications

Size	
Length	1.26 in [32 mm]
Width/Dia.	0.82 in [20.83 mm]
Weight	0.056 lbs [25.4 g]
Mating Cycles	500 Cycles
Mating Torque	19 to 21 in-lbs [2.15 to 2.37 Nm]

Material Specifications

Description	Material	Plating
Contact	Beryllium Copper	Gold over Nickel 50µ in. minimum
Insulation	PTFE	
Body	Passivated Stainless Steel	SAE-AMS-2700



Configuration:

- N Male Connector
- 50 Ohms
- Straight Body Geometry
- Harbour LL142 Interface Type
- Clamp/Solder Attachment
- 3/4 inch Hex

Features:

- Operating Frequency of 18 GHz Max.
- Excellent VSWR of 1.25:1
- Gold over Nickel Plated Beryllium Copper Contact
- 50µ in. minimum contact plating

Applications:

- General Purpose Test
- Custom Cable Assemblies

Fairview Microwave
 1130 Junction Dr. #100
 Allen, TX 75013
 Tel: 1-800-715-4396 / (972) 649-6678
 Fax: (972) 649-6689
www.fairviewmicrowave.com
sales@fairviewmicrowave.com

Coupling Nut

Passivated Stainless Steel

SAE-AMS-2700

Environmental Specifications

Temperature

Operating Range	-65 to +165 deg C
Humidity	MIL-STD-202, Method 106, No Vibration
Shock	MIL-STD-202, Method 213, Condition I
Vibration	MIL-STD-202, Method 204, Condition D
Thermal Shock	MIL-STD-202, Method 107, Condition B
Salt Spray	MIL-STD-202, Method 101, Condition B (5%)

Compliance Certifications (see [product page](#) for current document)

Plotted and Other Data

Notes:



Assembly Instruction

ASSEMBLY PROCEDURES

1. SLIDE CLAMP NUT (7) OVER CABLE. STRIP CABLE AS SHOWN. DO NOT NICK BRAID WHILE CUTTING JACKET.

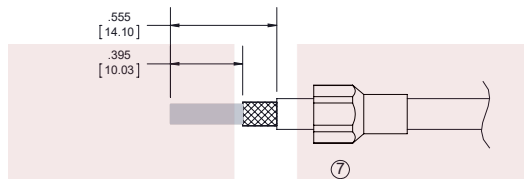

2. INSERT CABLE INTO SOLDER FERRULE (6) UNTIL CABLE STOP THEN SOLDER BOTH CABLE BRAIDS WHERE SHOWN. USING BLADES TO CUT DIELECTRIC FLUSH WITH FACE OF FERRULE. DO NOT NICK CENTER CONDUCTOR.

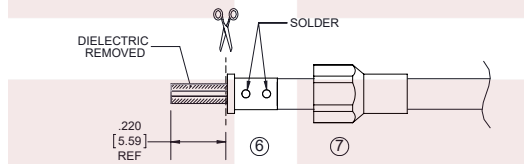

3. INSERT SPACER (5) AND CONTACT (4) INTO CALBE ASSEMBLY UNTIL STOP AND SOLDER CONTACT (4) TO CENTER CONDUCTOR. REMOVE EXCESS SOLDER. SLIDE INSULATOR (3) OVER CONTACT THEN INSERT CABLE ASSEMBLY INTO BODY (1) & TIGHTEN. INSERT RUBBER GASKER (2) INTO BODY COUPLING (1).

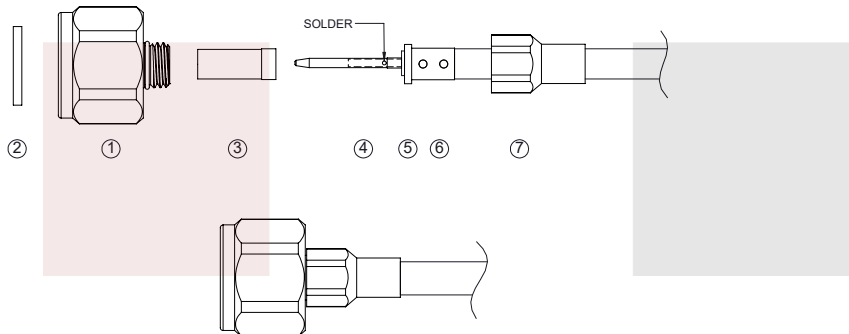

N Male Connector Clamp/Solder Attachment For Harbour LL142 Cable from Fairview Microwave is in-stock and available to ship same-day. All of our RF/microwave products are available off-the-shelf from our ISO 9001:2008 certified facilities in Allen, Texas. Fairview Microwave is RF on-demand.

For additional information on this product, please click the following link: [N Male Connector Clamp/Solder Attachment For Harbour LL142 Cable SC7231](#)

URL: <https://www.fairviewmicrowave.com/n-male-standard-harbour-ll142-connector-sc7231-p.aspx>

The information contained in this document is accurate to the best of our knowledge and representative of the part described herein. It may be necessary to make modifications to the part and/or the documentation of the part, in order to implement improvements. Fairview Microwave reserves the right to make such changes as required. Unless otherwise stated, all specifications are nominal. Fairview Microwave does not make any representation or warranty regarding the suitability of the part described herein for any particular purpose, and Fairview Microwave does not assume any liability arising out of the use of any part or documentation.



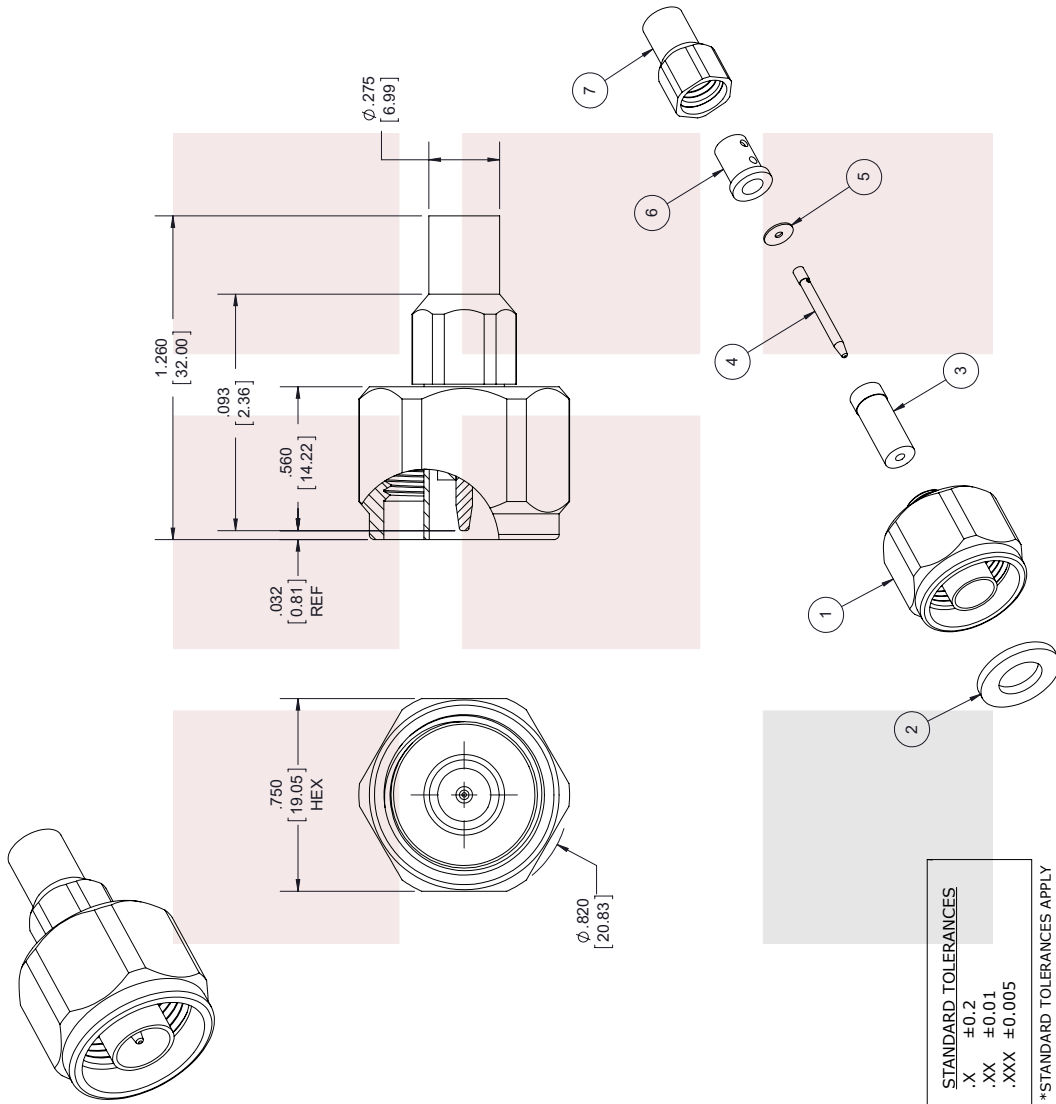

STANDARD TOLERANCES
 .X ±0.2
 .XX ±0.01
 .XXX ±0.005
 *STANDARD TOLERANCES APPLY
 ONLY TO DIMENSIONS IN INCHES

FAIRVIEW MICROWAVE INC. ALLEN, TX 75013 WWW.FAIRVIEWMICROWAVE.COM		DWG NO SC7231		CAGE CODE 3FKR5	
		CAD FILE 092217	SHEET 1 OF 1	SCALE N/A	SIZE A 7361
NOTES: 1. UNLESS OTHERWISE SPECIFIED ALL DIMENSIONS ARE NOMINAL. 2. ALL SPECIFICATIONS ARE SUBJECT TO CHANGE WITHOUT NOTICE AT ANY TIME. 3. DIMENSIONS ARE IN INCHES [mm].					

N Male Connector Clamp/Solder Attachment For Harbour LL142 Cable