

SMA RADIUS SOLDER POT .5in FLANGE

SC7508

SPECIFICATIONS

ELECTRICAL:

FREQUENCY: 0-18 GHZ
 IMPEDANCE: 50 OHMS
 VSWR: 1.25:1
 OP. TEMP RANGE: -55°C to +120°C

MECHANICAL:

MATERIAL BODY: PASS. STAINLESS STEEL
 CENTER CONTACT: BeCu
 CONTACT PLATING: Au MIL-G-45204
 INSULATOR: TEFLON
 INTERFACE: MIL-STD-883A

ROHS COMPLIANT

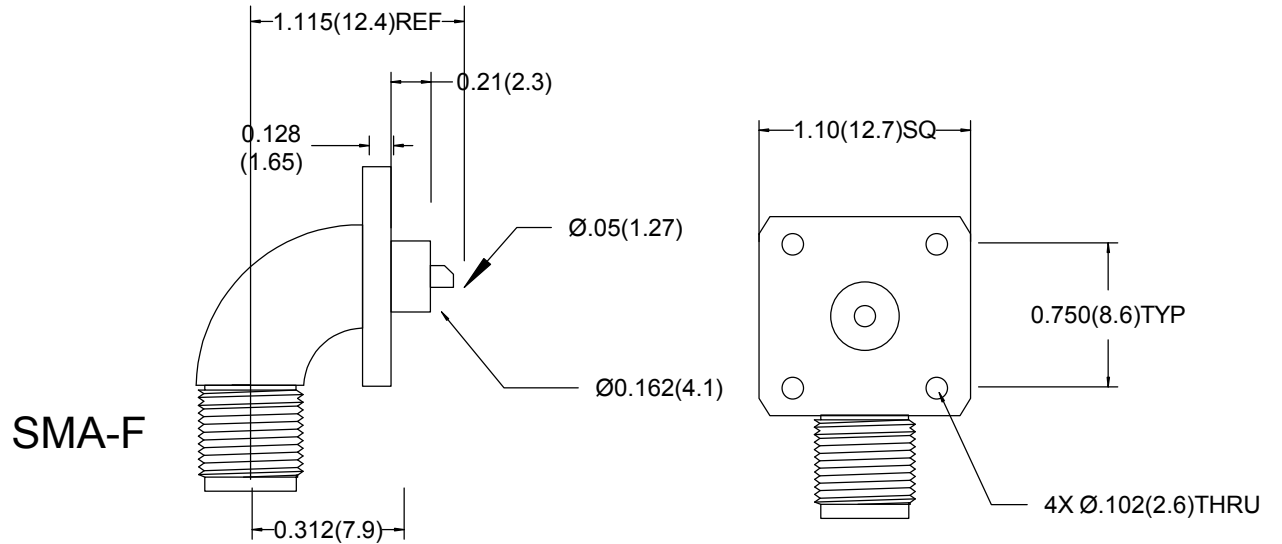

FAIRVIEW MICROWAVE INC.

ALLEN, TX 75013 WWW.FAIRVIEWMICROWAVE.COM

TITLE

SMA RADIUS SOLDER POT .5in FLANGE

ALL DIMENSIONS IN inches(MM) Typical	SIZE	CAGE CODE	DWG NO	REV
	A	3FKR5	SC7508	--
	SCALE		SHEET	