



SMA BULKHEAD PRESSMOUNT

SC8481

SPECIFICATIONS

ELECTRICAL

50 OHMS
VSWR 1.25:1 MAX @ 18 GHZ
FREQUENCY: 0-18 GHZ

MECHANICAL

MATERIAL BODY: PASS. S STEEL
MATERIAL CONTACTS: BeCu
CONTACT PLATING Au MIL-G-45204
CAPTIVATED CONTACT
INTERFACE MIL-STD-348
INSULATION: TEFLON
ROHS COMPLIANT

ENVIRONMENTAL

-65 DEG C TO +165 DEG C

SMA-F

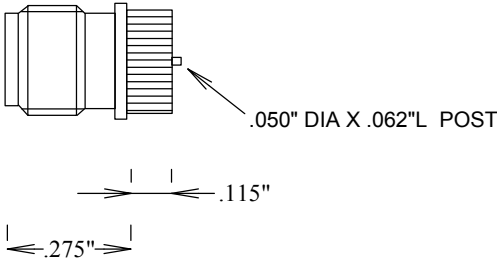

MOUNTING HOLE
.267" +/- .001

				FAIRVIEW MICROWAVE INC.			
				ALLEN, TX 75013 WWW.FAIRVIEWMICROWAVE.COM			
				TITLE			
				SMA BULKHEAD PRESSMOUNT			
SIZE	CAGE CODE	DWG NO				REV	
A	3FKR5	SC8481				--	
SCALE						SHEET	

