

ADAPTER M-UHF M TO UHF M

SM2156

SPECIFICATIONS

ELECTRICAL:

FREQUENCY: 0-500 MHZ
 WORKING VOLTAGE: 335 VRMS @ SEA LEVEL

MATERIALS:

BODY: NICKEL PLATED BRASS
 CONTACT: SILVER PLATED BRASS
 INSULATOR: DELRIN
 PRESSURE WASHER: NICKEL PLATED BRASS

MECHANICAL:

ROHS COMPLIANT

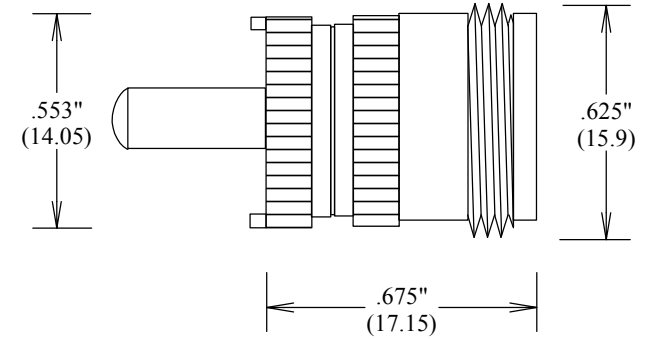
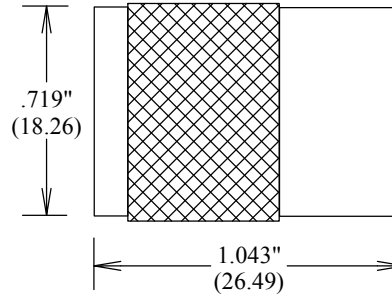

MEASUREMENTS BELOW ARE TYPICAL

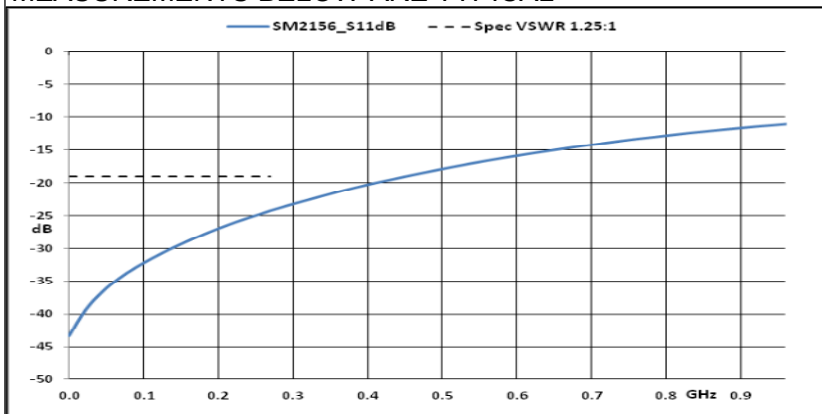

ALL DIMENSIONS IN inches(mm) Typical

FAIRVIEW MICROWAVE INC.			
ALLEN, TX 75013 WWW.FAIRVIEWMICROWAVE.COM			
TITLE			
ADAPTER M-UHF M TO UHF M			
SIZE	CAGE CODE	DWG NO	REV
A	3FKR5	SM2156	--
SCALE		SHEET	