

# MMCX-PLUG RG174 RG316 CRIMP

SC9515

## SPECIFICATIONS

### ELECTRICAL:

FREQUENCY: 0-6 GHZ  
 VSWR 1.25:1 MAX  
 IMPEDANCE: 50 OHMS  
 OP. TEMP RANGE: -55C to +125C

### MECHANICAL:

MATERIAL BODY: BRASS AU PLATING 3μ"  
 CENTER CONTACT: Brass  
 CONTACT PLATING: Au MIL-G-45204  
 INSULATOR: TEFLON

### ASSEMBLY

TRIM CABLE AS SHOWN,  
 SLIDE CRIMP SLEEVE ON CABLE,  
 SOLDER ON CONTACT,  
 INSERT CABLE INTO BODY,  
 CRIMP

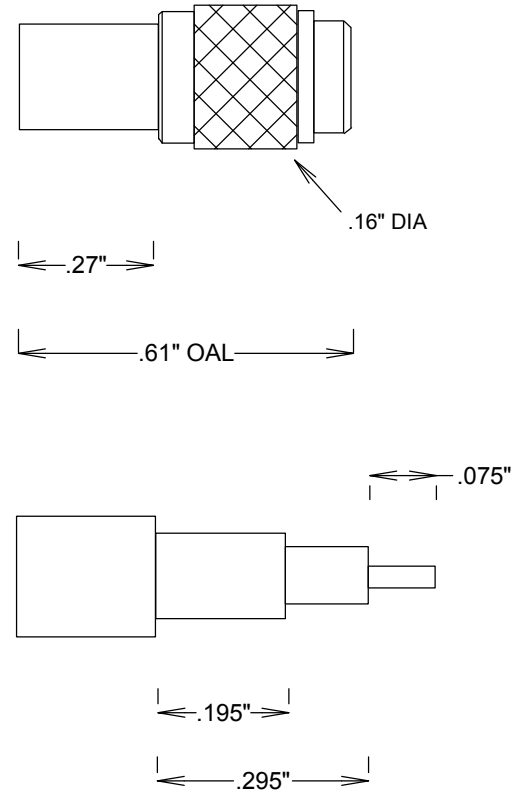

STRIPPING DIMENSIONS

				<b>FAIRVIEW MICROWAVE INC.</b>			
				ALLEN, TX 75013 WWW.FAIRVIEWMICROWAVE.COM			
				TITLE			
				<b>MMCX-PLUG RG174 RG316 CRIMP</b>			
SIZE		CAGE CODE		DWG NO		REV	
<b>A</b>		<b>3FKR5</b>		<b>SC9515</b>			
SCALE				SHEET			